

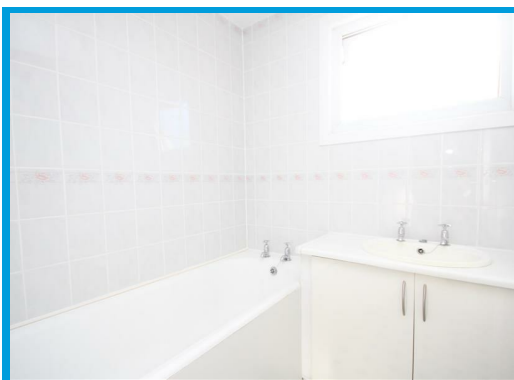

Parsons Green, Guildford, Surrey GU1 1QY

Offers In Excess Of £370,000

Located within a quiet residential cul de sac, this three bedroom house offers spacious accommodation within easy access to Guildford town centre.



Description

Positioned in a quiet location moments walk from local shops and main bus routes, this spacious three bedroom house is offered with no onward chain.

The ground floor accommodation comprises a kitchen/ diner and a large lounge with ample storage and sliding patio doors leading directly into the rear garden.

The first floor comprises two large double bedrooms, a further single bedroom and a family bathroom. There is also a separate cloakroom.

Externally the property offers a large frontage and a secluded rear garden which has external access via a residents alleyway.

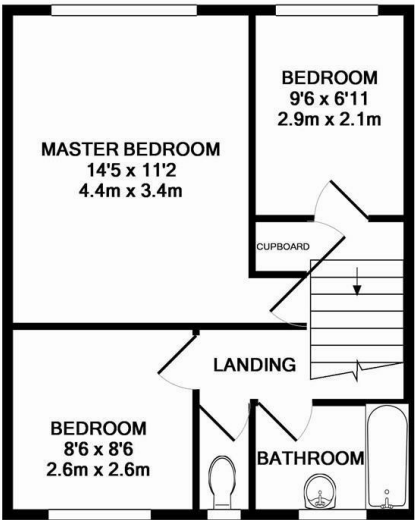
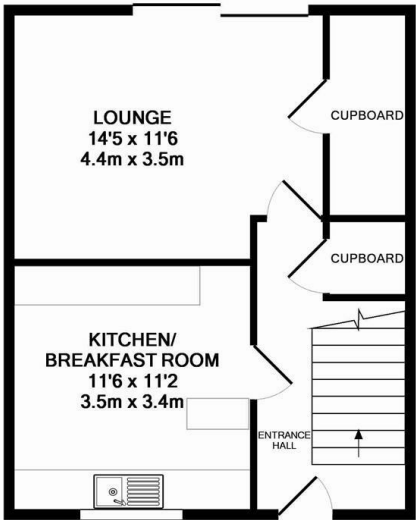

TOTAL APPROX. FLOOR AREA 843 SQ.FT. (78.3 SQ.M.)

Whilst every attempt has been made to ensure the accuracy of the floor plan contained here, measurements of doors, windows, rooms and any other items are approximate and no responsibility is taken for any error, omission, or mis-statement. This plan is for illustrative purposes only and should be used as such by any prospective purchaser. The services, systems and appliances shown have not been tested and no guarantee as to their operability or efficiency can be given

Made with Metropix ©2016

